

210x330mm

«SafetyGate Lucas HS131»

IMPORTANT! READ AND FOLLOW THESE INSTRUCTIONS CAREFULLY AND KEEP FOR FUTURE REFERENCE.

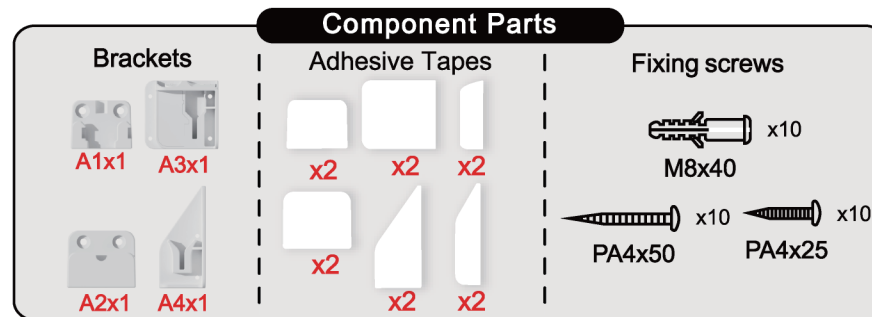
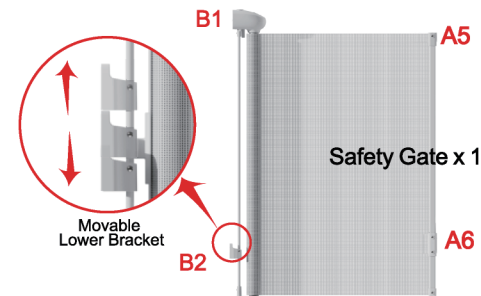

Warm Notice:

*Before installation, make sure the suitable screws for the surface.

*Shorter Screws are used on the wood surface.

PA4x25

Note 1: According to the hardness of wood surface, if necessary you may pre-drill holes within 2.5mm diameter before applying the screw.

PA4x50

*Longer screws and Expansion Screws are used in solid wall such as concrete wall or tile wall which with skirt board.

M8x40

Note 2: Please pre-drill the holes on the hardwall before use expansion tube.

PA4x25

*Shorter screws and Expansion Screws are used in solid wall such as concrete wall or tile wall which without skirt board.

M8x40

Location Fixing Position

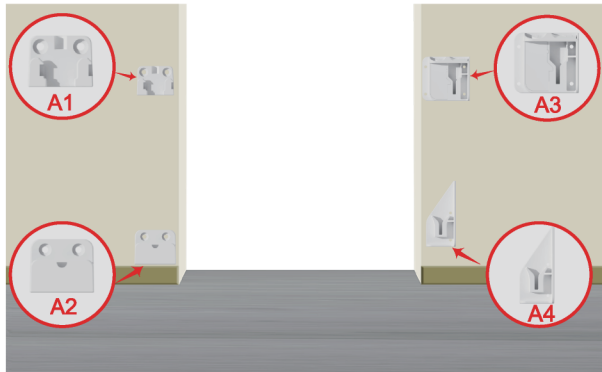

Warning

Before installation, make sure A3 and A4 to be used on proper surface.

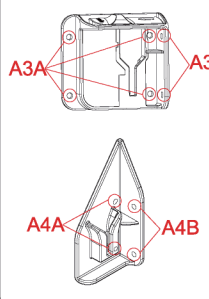

* If A3 and A4 are fix on the same plane, compare to the surface of A1 & A2, screws should be mounting on the A3A/A4A holes.
* If A3 and A4 are fix on the intersection angle, compared to the surface of A1&A2, screws should be mounting on the A3B/A4B holes.

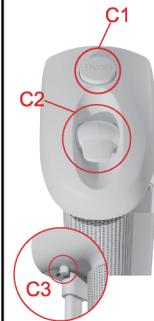

For doorways, hallways and bottom of stairs.



Stairways



Door frame

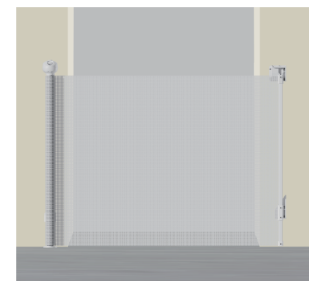

Doorways

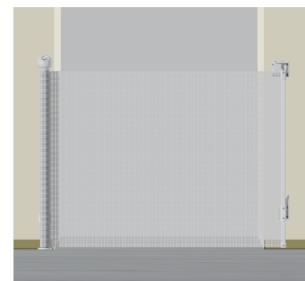

Baseboard

Troubleshooting:

If hooking the A5&A6 into the brackets is difficult, verify the following:

- The brackets are level.
- The horizontal distances between the top brackets and the bottom brackets are equal.
- The brackets are directly vertical (plumb) of each other on each side of the doorway. For best results, use a slow and smooth motion to hook the A5&A6 to the brackets.

WARNING

- «SafetyGate Lucas HS131»
- If there is baseboard at the wall, please adjust the position of the lower bracket according to the baseboard. If there is no baseboard at the wall, please do not posit the lower bracket over 12cm from the floor.
- Safety gate is suitable for use with children from 6 months up to 24 months of age.
- To install the gate outside the door frame, a standard 140cm wide mesh gate is recommended for door opening within 110cm, recommending to reserve 30cm mesh length for safety; For example, a 180cm wide mesh gate is suitable for door opening within 150cm, while a 350cm wide mesh gate is suitable for door opening within 320cm.
- To prevent serious injury or death, securely install gate or enclosure and use according to manufacturer's instructions.
- Never leave child unattended when using this product.
- Incorrect installation can be dangerous.
- Do not use the safety gate if any components are damaged or missing.
- The safety gate must not be fitted across windows and suspended positions.
- Never use with a child able to climb over or dislodge the gate or enclosure.
- Danger to older children if climbing over the product.
- Forbidden to install this product on glass doors. Install this product against reliable doors or walls.
- Forbidden to install the safety gate at the top of the stairs.
- (If necessary, the gate must be installed not closer than 20 cm from first step if installed in top of stairs!)
- If the product is used at the bottom of stairs, in order to prevent child climbing upstairs, it should be positioned on the lowest step.
- Do not put any goods which can be grabbed by children or pets near this product to prevent injury.
- Before using this product, carefully inspect for any loose parts and whether any parts needs to be tightened.
- Make sure the product to be installed is horizontal and flat on the floor.
- Regularly check that the safety gate is properly installed and secured.
- Safety gate must be fitted between rigid surfaces such as timber or hard wall.

210x330mm

Installation

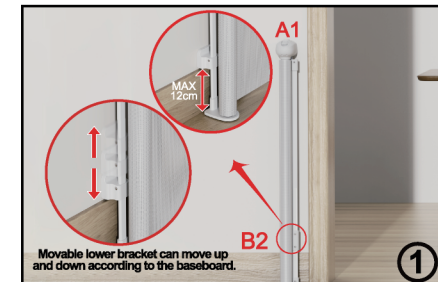

1. Apply the safety gate to the wall lightly, adjust the height of the movable lower bracket and fix it with screws. Then place A1&A2 into B1&B2 respectively. (If there is no baseboard on the wall, please do not posit the lower brackets B2 over 12cm up from the floor.)



4. Make sure A1&A2 are vertical to the ground, mark the screw holes of A1, A2.

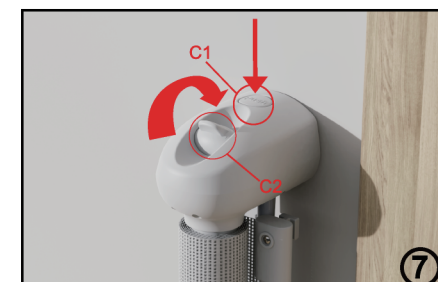

7. Keep pressing PUSH button C1 downward to the end and keep it there. Then pull up the rotary button to C2 the end and release it. At this point, baby gate mesh will keep unlocked state and maintained for 25-35 seconds.

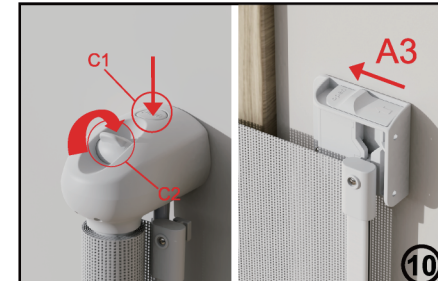

10. Keep pressing PUSH button C1 downward to the end and pull up the rotary button to C2. Walk to right, push the top button to left to unlock it. (Noted: The A3 button will be reset automatically.) Lift the mesh handle bar upwards and remove it out from the brackets. Then the mesh retract back.

Take note 1 Please always put the lower bracket B2 as close to the baseboard/skirting board. (If there is no baseboard/skirting board on the wall, please do not posit the lower bracket B2 over 12cm up from the floor.)

Take note 2 Please adjust the position of A1, A2, A3 and A4, then pull out the mesh to check if it is balance, and make sure that the mesh is level.

Take note 3 Please pre-drill the holes on the hardwall before use expansion tube.



2. Clean the surface and leave to dry thoroughly, then tear off the release paper from the tapes on brackets (A1&A2), do NOT touch the adhesive, stick the safety gate on the wall.

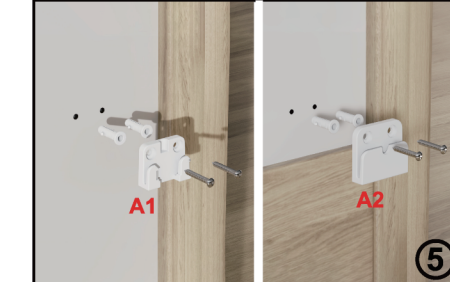

5. Remove the brackets (A1, A2) from the wall. Drill the screw holes at the marked points. Insert the expansion tubes, and then use the screws to fix brackets (A1, A2) properly.

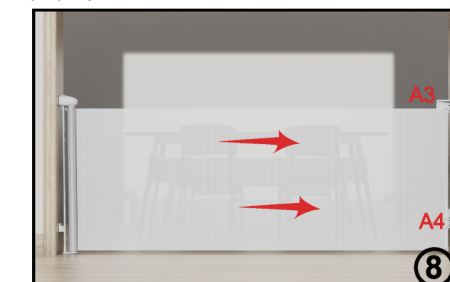

8. Open the baby gate mesh and keep its surface vertical and flattening. Apply A3 and A4 to the desired position, and mark the screw holes of A3 and A4 accordingly. Make sure A3 and A4 are vertical to the ground.

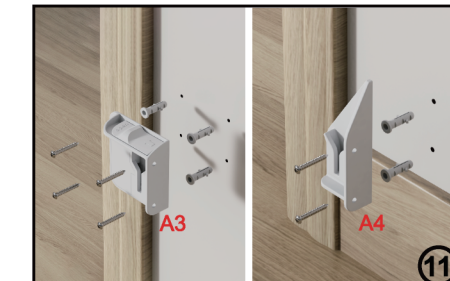

11. Mark the screw holes with a pen, drill the screw holes on the marked positions. Install the expansion nails, brackets (A3, A4) and screws properly.

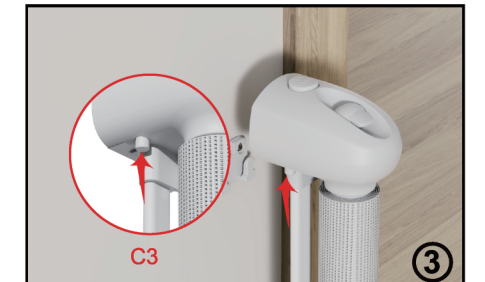

3. Keep pressing the button C3 and lift it up, safety gate can be removed out from the brackets A1&A2.



6. Installed baby gate, place the B2 into A2, buckle B1 into A1. Make sure that A1&B1, A2&B2 is buckled into the gap well respectively.

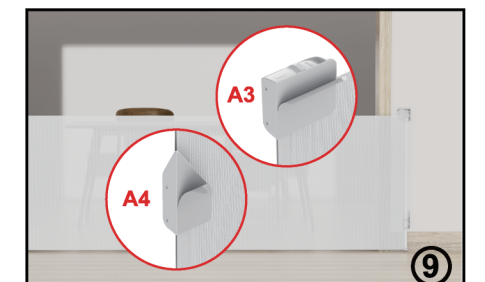

9. Tear off the release paper from the bracket, stick the bracket, (A3, A4) to the wall. Noted: To prevent the Influence Positioning from baby gate mesh pulling force, please retract the mesh back.



12. The installation of the baby gate has been completed.

To Use

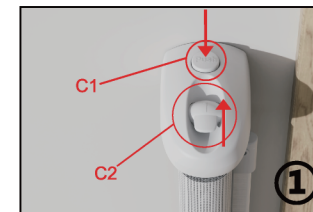

1. Keep pressing PUSH button C1 downward to the end and keep it there. Then pull up the rotary button to C2 the end and release it. At this point, baby gate mesh will keep unlocked state and maintained for 25-35 seconds.

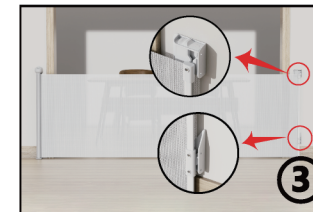

3. Make sure that A5 & A6 are hooked well in A3 & A4.

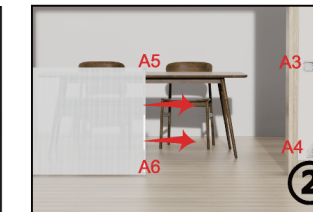

2. Hold the handle and open the baby gate mesh and keep its surface vertical and flattening. hook A5 & A6 to A3 & A4 well respectively.

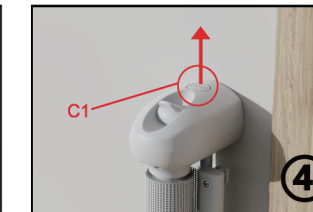

4. After baby gate installed well, already take 25-35 seconds. C1 button will be self-rebounding to lock the mesh. Ensure mesh locked well.

To Remove The Gate From The Wall

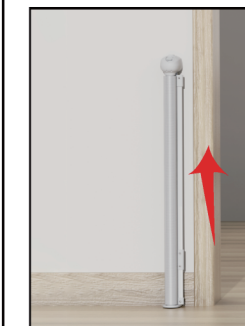

Press C3 button, and lift it up to remove the gate easily.

Improper Installation

